

ITEM NO.	DESCRIPTION	MAN.P/NO.	D&S P/NO.
1	Discharge, 9-23 Stages	0050100RP	DS2-1A
1	Discharge, 33-65 Stages	0050100L0RP	DS2-1B
2	Valve Casing	0050200	DS2-2
3	Valve guide	0050300	NSI
4	Valve cone	0050400	NSI
12	Diffuser - 9/18/23 Stages	0051200	DS2-12A
12	Diffuser - 33-65 Stages	0051200L0	DS2-12B
18	Impeller	0101800	DS2-18
24	Stop Ring	0052400	DS2-24
26	Spacing washer for stop ring	0052600	DS2-26
34	Strainer - 9/18/23 Stages	0053400	DS2-34A
34	Strainer -33-65 Stages	0053400L0	DS2-34B
36	Suction Interconnector - 9/18/23	0053600	DS2-36A
36	Suction Interconnector -33-65	0403600	DS2-36B
40	Pump shaft/Coupling - 9 Stage	005370009	DS2-40A
40	Pump shaft/Coupling -18 Stage	005370018	DS2-40B
40	Pump shaft/Coupling - 23 Stage	005370023	DS2-40C
40	Pump shaft/Coupling - 33 Stage	005370033	DS2-40D
40	Pump shaft/Coupling - 48 Stage	005370048	DS2-40E
40	Pump shaft/Coupling - 65 Stage	005370065	DS2-40F

NSI - Non stock item available on special order only

ITEM NO.	DESCRIPTION	MAN.P/NO.	D&S P/NO.
42	Shaft sleeve	0054200	DS2-42
47	Strap - 9 Stage	005470009	NSI
47	Strap - 18 Stage	005470018	NSI
47	Strap - 23 Stage	005470023	NSI
47	Strap - 33 Stage	005470033	DS2-47A
47	Strap - 48 Stage	005470048	NSI
47	Strap - 65 Stage	005470065	DS2-47B
52	Cable guard - 9 Stage	005520009	NSI
52	Cable guard - 18 Stage	005520018	NSI
52	Cable guard - 23 Stage	005520023	NSI
52	Cable guard - 33 Stage	005520033	NSI
52	Cable guard - 48 Stage	005520048	NSI
52	Cable guard - 65 Stage	005520065	NSI
86	Valve seat	0058600	DS2-86
87	Neck ring	0058700	DS2-87
88	Screw M5	J04M08	NSI
89	Bearing	0058900	DS2-89
90	Scre M8	J02M0830	NSI
91	Washer	0059100	NSI
93	Lock nut	0059300	NSI

NSI - Non stock item available on special order only

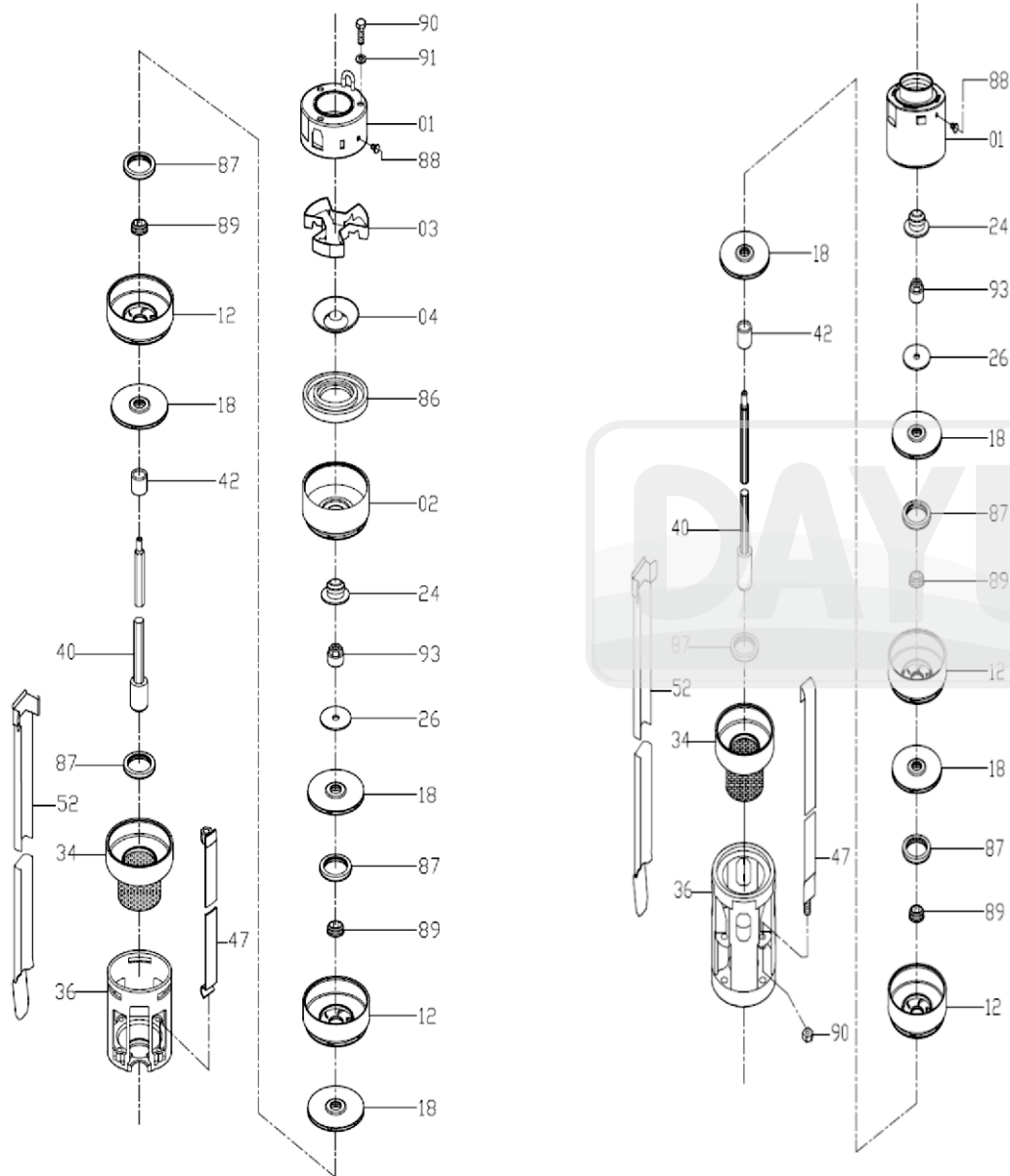

REPAIR KIT DS2/3/5				
No.	Description	5STG	15STG	30STG
DS2-86	VALVE SEAT DS2/3/5	1	1	1
DS2-87	NECK RING DS2/3/5	5	15	30
DS2-89	BEARING DS2/3/5	5	15	30
DS2-24	STOP RING	1	1	1
DS2-26	SPACING WASHER FOR STOP RING	1	1	1