

ITEM NO.	DESCRIPTION	MAN.P/NO.	D&S P/NO.
1	Discharge chamber	0400100RP	DS8-1
4	Valve cone	0050400	NSI
10	Bearing	0401000	DS8-10
12	Diffuser	0401200	DS8-12
18	Impeller	0401800	DS8-18
21	Split Cone	0402100	DS8-21
22	Split cone nut	0402200	DS8-22
28	Bottom Diffuser	0402800	DS8-28
34	Strainer	0403400	DS8-34
36	Suction interconnector	0403600	DS8-36
40	Pump shaft/ Coupling-10 stage	040370010	DS8-40A
40	Pump shaft/ Coupling- 15 stage	040370015	DS8-40A
40	Pump shaft/ Coupling- 25 stage	040370025	DS8-40C
40	Pump shaft/ Coupling- 37 stage	040370037	DS8-40C
NSI - Non stock item available on special order only			

ITEM NO.	DESCRIPTION	MAN.P/NO.	D&S P/NO.
40	Pump shaft/ Coupling- 50 stage	040370050	DS8-40D
47	Strap - 10 stage	040470010	NSI
47	Strap - 15 stage	040470015	NSI
47	Strap -25 stage	040470025	NSI
47	Strap -37 stage	040470037	NSI
47	Strap -50 stage	040470050	NSI
52	Cable Guard - 10 stage	040520010	NSI
52	Cable Guard - 15 stage	040520015	NSI
52	Cable Guard - 25 stage	040520025	NSI
52	Cable Guard - 37 stage	040520037	NSI
52	Cable Guard - 50 stage	040520050	NSI
86	Valve seat	0408600	DS8-86
88	Nut	J04M08	NSI
89	Bearing	0408900	NSI
NSI - Non stock item available on special order only			

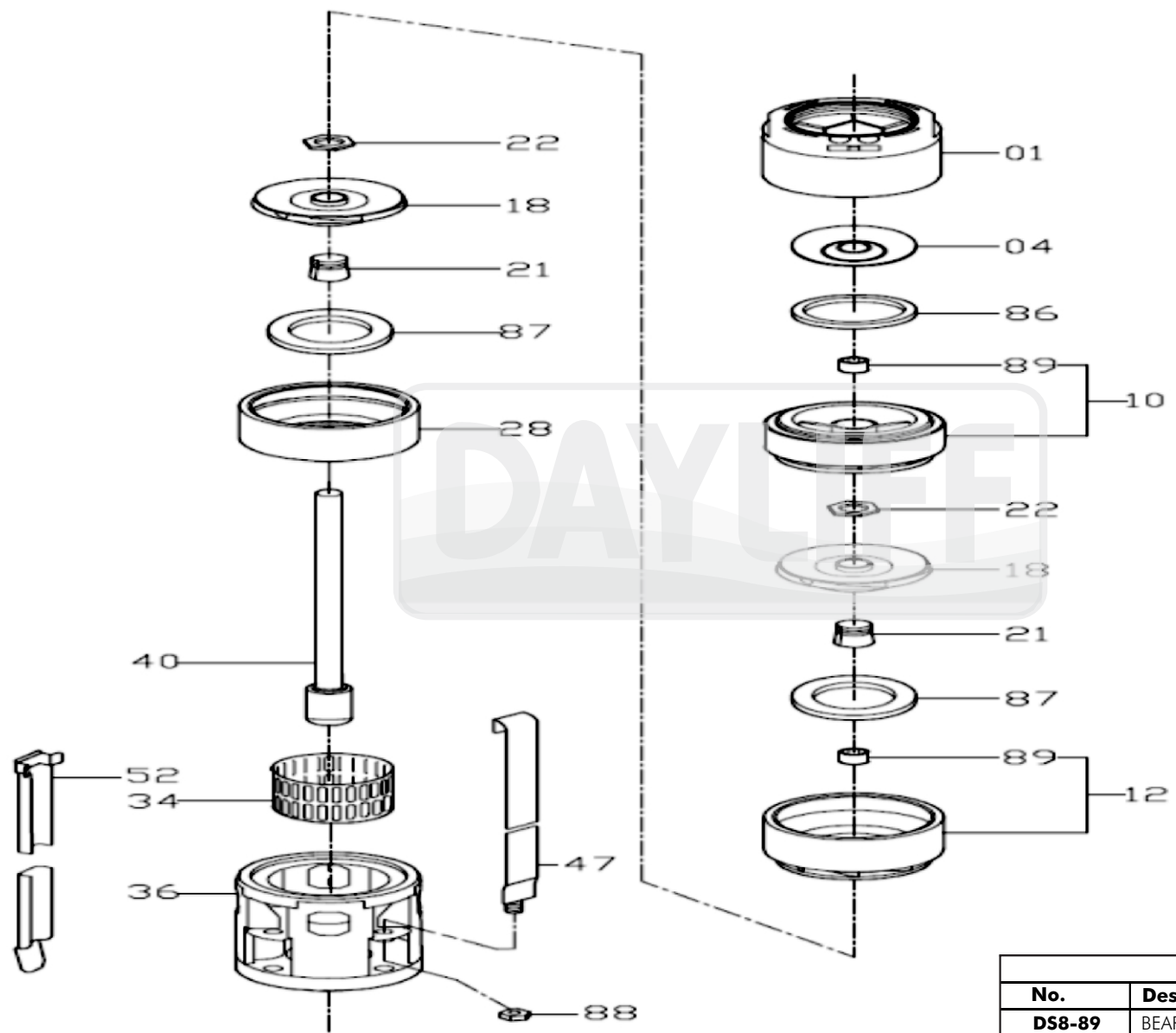

REPAIR KIT DS8			
No.	Description	5STG	10STG
DS8-89	BEARING DS8	5	10
DS8-87	NECK RING DS8	5	10