

GRUNDFOS®



DATA SHEET

Sanitary
Pumps

F&B HYGIA I



1450rpm

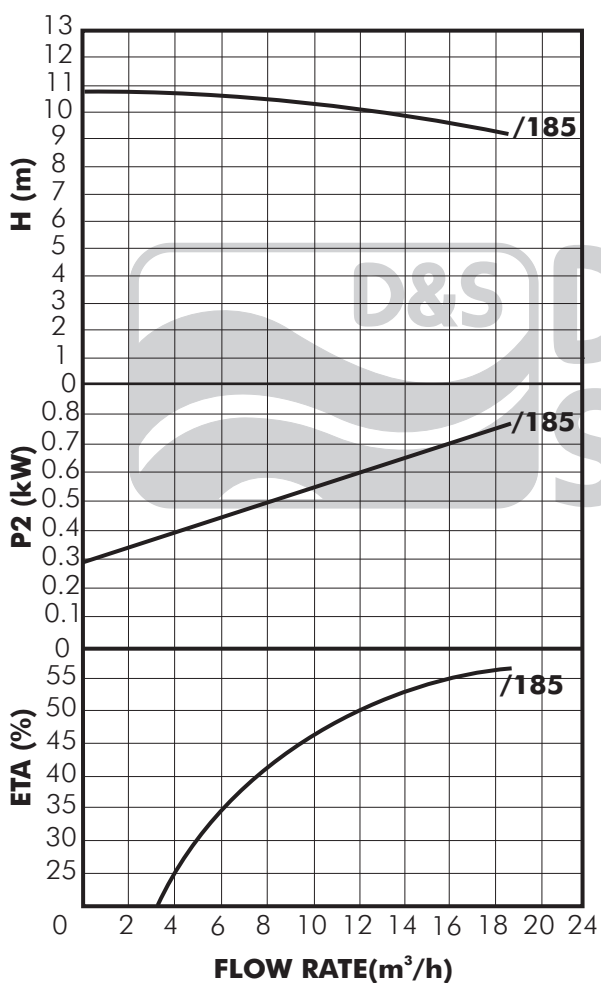

2900rpm

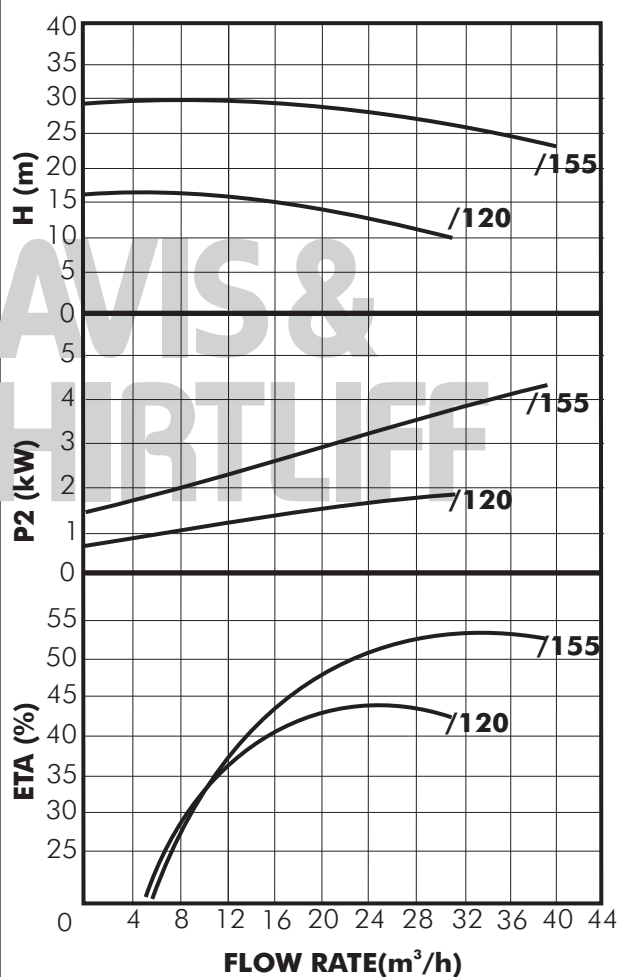

PUMP

Grundfos Hygia sanitary pumps are of single stage end suction type fitted with semi-open impellers specifically designed to meet the hygiene requirements of sterile operating processes. They are suitable for various applications in the food and beverage industry including drinks, dairy, confectionery and meat packing industries. The design features optimised hydraulics for high efficiency, stainless steel motor shroud and polished internal finishes to prevent fouling by bacteria and germs.

Pump hydraulic end construction is CrNrMo AISI 316L stainless steel throughout. Two and four pole motor options are available and impellers can be trimmed to provide specific duties.

MOTOR

Pumps are fitted with Grundfos MG fan-cooled synchronous three phase close coupled electric motors. DOL starter control is required for motor protection.

Enclosure Class: IP55

Insulation Class: F

Voltage: 3x415V

OPERATING CONDITIONS

Pumped Liquid: Low viscosity fluids containing some particles

Maximum Operating Pressure: 16 bar

Minimum Temperature Maximum: 95°C

MOTOR DATA

Model	Impeller diameter (mm)	Speed (rpm)	Power (kW)	Max Current, (A)	DN (mm)	Weight (Kg)
Hygia 1 4 pole	185	1450	1.1	2.6	40	20
Hygia 1 2 pole	120	2900	2.2	4.4	40	29
Hygia 1 2 pole	155	2900	4.0	10	50	35

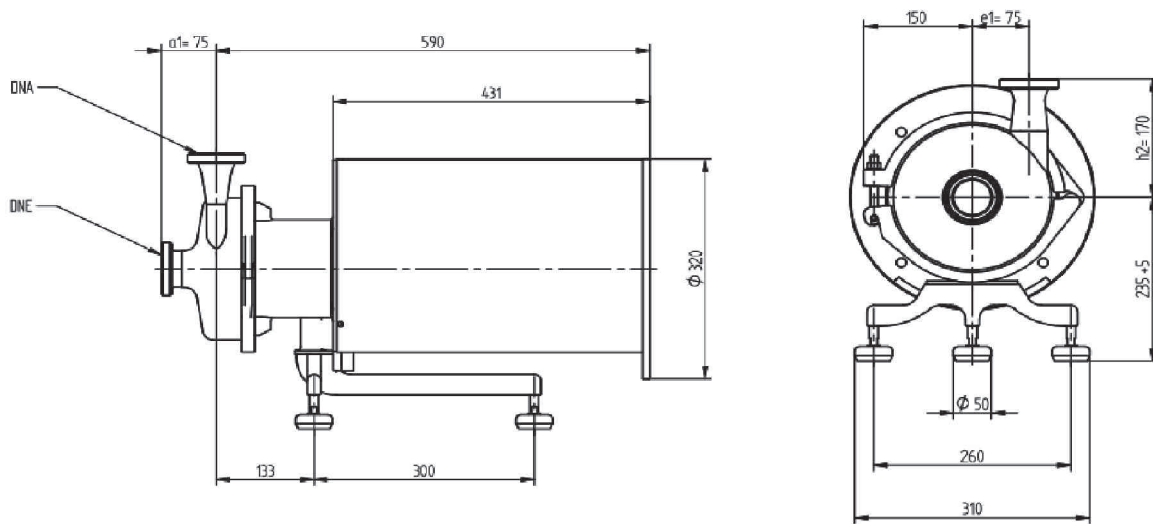

All dimensions in mm

© Davis & Shirtliff 2014. Contents herein are not warranted. The right is reserved to amend specifications without notice. www.davisandshirtliff.com

GR244B-08/14

KENYA
NAIROBI - HEAD OFFICE
 TEL: (+254 20) 6968 000
 headoffice@dayliff.com
NAIROBI - WESTLANDS
 TEL: (+254 20) 44480116,
 westlands@dayliff.com
NAIROBI - DOWNTOWN
 TEL: (+254 20) 340102
 downtown@dayliff.com
NAIROBI - KAREN
 TEL: (+254 20) 3883513
 karen@dayliff.com
THIKA
 TEL: (+254 67) 20084/5
 thika@dayliff.com
ELDORET
 TEL: (+254 53) 2061306
 eldoret@dayliff.com

NAKURU
 TEL: (+254 51) 2213248
 nakuru@dayliff.com
KISUMU
 TEL: (+254 57) 2024763
 ksmoffice@dayliff.com
KISII
 TEL: (+254 58) 2030949
 ksil@dayliff.com
NAIVASHA
 TEL: (+254 50) 2030510
 naivasha@dayliff.com
MACHAKOS
 TEL: (+254 40) 2021668
 naivasha@dayliff.com
MERU
 TEL: (+254 64) 3131033
 meru@eld.dayliff.com

GARISSA
 TEL: (+254 46) 2102620
 garissa@dayliff.com
KENYA COAST
MOMBASA - Main Office
 TEL: (+254 20) 2040432
 d&smasa@dayliff.com
MALINDI
 TEL: (+254 42) 2120425
 mldoffice@dayliff.com
DIANI
 TEL: (+254 40) 3202181
 dianioffice@dayliff.com
LAMU
 TEL: (+254 20) 265105256
 lamu@dayliff.com

NYALI
 TEL: (+254 20) 2443357
 d&s@nyali.dayliff.com
VOI
 TEL: (+254 20) 2028284
 voi@dayliff.com
ETHIOPIA
ADDIS ABABA
 TEL: (+251 11) 515934144
 d&sethiopia@dayliff.com
RWANDA
KIGALI
 TEL: (+250 252) 504039
 rwoffice@dayliff.com

UGANDA
KAMPALA - Main Office
 TEL: (+256 414) 346337/8
 d&skampala@dayliff.com
KAMPALA - NAKESERO
 TEL: (+256 392) 734633
 d&snakesero@dayliff.com
GULU
 TEL: (+256 471) 433041
 d&sgulu@dayliff.com
MBARARA
 TEL: (+256 753) 940 080
 d&smbarara@dayliff.com

TANZANIA
DAR ES SALAAM - Main Office
 TEL: (+255 22) 21125156
 d&sdarressalaam@dayliff.com
DAR ES SALAAM - KARIAKOO
 TEL: (+255 392) 2184867
 d&skariakoo@dayliff.com
ARUSHA
 TEL: (+255 27) 2547317/8
 arusha@dayliff.com
ZANZIBAR
 TEL: (+255 24) 2234660/1
 zanzibar@dayliff.com
MWANZA
 TEL: (+255 28) 2541971/2
 d&smwanza@dayliff.com

ZAMBIA
LUSAKA - Main Office
 TEL: (+260 211) 288010/1
 d&slusaka@dayliff.com
NDOLA
 TEL: (+260 212) 610936/7
 d&sndola@dayliff.com
KITWE
 TEL: (+260 212) 221747/67
 d&skitwe@dayliff.com
LIVINGSTONE
 TEL: (+260 213) 320002/234
 d&slivingstone@dayliff.com
SOUTH SUDAN
JUBA
 TEL: (+211 956) 397 070
 juba@dayliff.com