

GRUNDFOS®



DATA SHEET

Rotary Sanitary Pumps

NOVALobe



Bi-wing lobe rotor

PUMP

Grundfos NOVALobe sanitary pumps are of the rotary lobe positive displacement type specifically designed for the transfer of viscous liquids in a wide range of hygiene and sanitary applications including food and beverages, pharmaceuticals, pulp, paper, paint, adhesives etc. They are designed to meet the strictest hygiene requirements complying with various international standards and feature a highly polished surface finish, FDA approved elastomers and sterile joints and seals to prevent fouling by bacteria and germs.

Pump hydraulic end construction is AISI 316L throughout with EPDM seals and silicon carbide mechanical seal. The pump is designed for robust performance and features close rotor clearances for improved efficiency. The standard rotor is of bi-wing type, though other rotor designs and customised specifications are available for special applications. Pumps are supplied bare shaft though are available base frame mounted with motor to order.

OPERATING CONDITIONS

Max viscosity: 1,000,000cP

Max operating temp: 150°C

Max differential pressure: 16 bar

Max operating pressure: 40 bar

PUMP PERFORMANCE

| Model | Max Displacement (l/rev) | Output @ 1000rpm (m ³ /hr) | Power Absorbed at Delivery Pressure, kW | | | | | | | | DN (mm) | Maximum Particle Size (mm) | Weight (Kg) |
|----------------|--------------------------|---------------------------------------|---|------|-------|-------|-----------------|------|-------|-------|---------|----------------------------|-------------|
| | | | 10cP Viscosity | | | | 100cP Viscosity | | | | | | |
| | | | 2Bar | 5Bar | 10Bar | 15Bar | 2Bar | 5Bar | 10Bar | 15Bar | | | |
| 10/0.06 | 0.06 | 3.6 | 0.3 | 0.8 | 1.3 | 1.8 | 0.5 | 0.8 | 1.5 | 2 | 25 | 12 | 9 |
| 20/0.12 | 0.12 | 7.2 | 0.9 | 1.5 | 2.8 | 4 | 1.2 | 2.0 | 3 | 4.5 | 40 | 16 | 19 |
| 30/0.22 | 0.22 | 13.2 | 2.0 | 3.2 | 5.8 | 8 | 3.5 | 4.5 | 7 | 9 | 50 | 17 | 44 |

Note that output and power absorbed will depend upon speed and liquid viscosity. Consult Davis & Shirliff for specific applications.

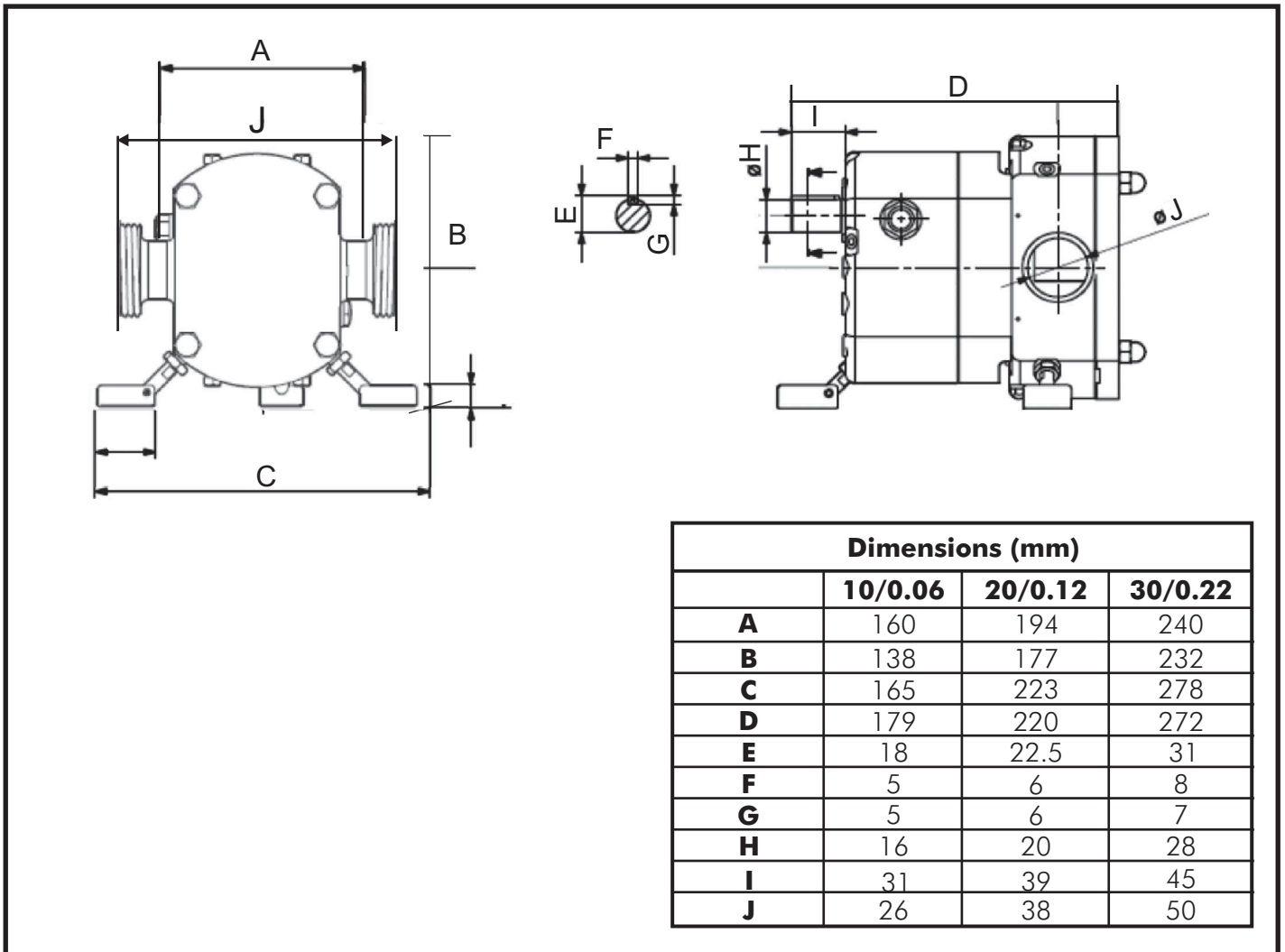

KENYA
NAIROBI - HEAD OFFICE
 TEL: (+254 20) 6968 000
 headoffice@dayliff.com
NAIROBI - WESTLANDS
 TEL: (+254 20) 44480116,
 westlands@dayliff.com
NAIROBI - DOWNTOWN
 TEL: (+254 20) 340102
 downtown@dayliff.com
NAIROBI - KAREN
 TEL: (+254 20) 3883513
 karen@dayliff.com
THIKA
 TEL: (+254 67) 20084/5
 thika@dayliff.com
ELDORET
 TEL: (+254 53) 2061306
 eldoret@dayliff.com

NAKURU
 TEL: (+254 51) 2213248
 nakuru@dayliff.com
KISUMU
 TEL: (+254 57) 2024763
 ksmoffice@dayliff.com
KISII
 TEL: (+254 58) 2030949
 ksisii@dayliff.com
NAIVASHA
 TEL: (+254 50) 2030510
 naivasha@dayliff.com
MACHAKOS
 TEL: (+254 40) 2021668
 naivasha@dayliff.com
MERU
 TEL: (+254 64) 3131033
 meru@eld.dayliff.com

GARISSA
 TEL: (+254 46) 2102620
 garissa@dayliff.com
KENYA COAST
MOMBASA - Main Office
 TEL: (+254 20) 2040432
 d&smasa@dayliff.com
MALINDI
 TEL: (+254 42) 2120425
 mldoffice@dayliff.com
DIANI
 TEL: (+254 40) 3202181
 dianioffice@dayliff.com
LAMU
 TEL: (+254 20) 265105256
 lamu@dayliff.com

NYALI
 TEL: (+254 20) 2443357
 d&snlyali@dayliff.com
VOI
 TEL: (+254 20) 2028284
 voi@dayliff.com
ETHIOPIA
ADDIS ABABA
 TEL: (+251 11) 515934144
 d&sethiopia@dayliff.com
RWANDA
KIGALI
 TEL: (+250 252) 504039
 rwoffice@dayliff.com

UGANDA
KAMPALA - Main Office
 TEL: (+256 414) 346337/8
 d&skampala@dayliff.com
KAMPALA - NAKESERO
 TEL: (+256 392) 734633
 d&snakesero@dayliff.com
GULU
 TEL: (+256 471) 433041
 d&sgulu@dayliff.com
MBARARA
 TEL: (+256 753) 940 080
 d&smbarara@dayliff.com

TANZANIA
DAR ES SALAAM - Main Office
 TEL: (+255 212) 212515/6
 d&sdarressalaam@dayliff.com
DAR ES SALAAM - KARIAKOO
 TEL: (+255 22) 2184867
 d&skariakoo@dayliff.com
ARUSHA
 TEL: (+255 27) 2547317/8
 arusha@dayliff.com
ZANZIBAR
 TEL: (+255 24) 2234660/1
 zanzibar@dayliff.com
MWANZA
 TEL: (+255 28) 2541971/2
 d&smwanza@dayliff.com

ZAMBIA
LUSAKA - Main Office
 TEL: (+260 211) 288010/1
 d&slusaka@dayliff.com
NDOLA
 TEL: (+260 212) 610936/7
 d&sndola@dayliff.com
KITWE
 TEL: (+260 212) 221747/6/7
 d&skitwe@dayliff.com
LIVINGSTONE
 TEL: (+260 213) 320002/234
 d&slivingstone@dayliff.com
SOUTH SUDAN
JUBA
 TEL: (+211 956) 397 070
 juba@dayliff.com