

# SAWO

## DATA SHEET

## Steam & Sauna Rooms

SAWO is well known for its quality range of sauna and steam heaters and accessories and also offer rooms in component form that are easily assembled and include all items for a complete installation. This provides benefits of cost, installation simplicity and performance as each unit is engineered for optimised efficiency and value. Complete SAWO rooms are the ideal solution for steam and sauna facilities in private homes, health clubs and hotels that remove all the problems of individually specified installations.

### STEAM ROOM

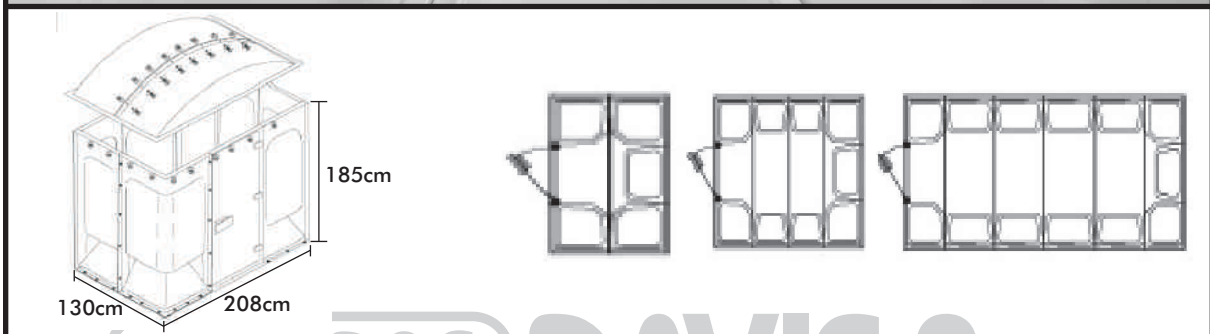

Steam rooms are designed to seat 4 people and are constructed from light modular acrylic panels and are simply bolted together on site. The unit includes four corner sections and a glass door and also a 6kW Plus-Series 1 ph/3ph steam generator, an essence/aroma pump, a protected steam head and an illuminated demand button.

Steam room size is 2.08m x 1.3m x 1.85m height, a capacity of 5m<sup>3</sup>, though due to the modular construction design rooms suitable for up to 12 people are available.

# SAUNA ROOM

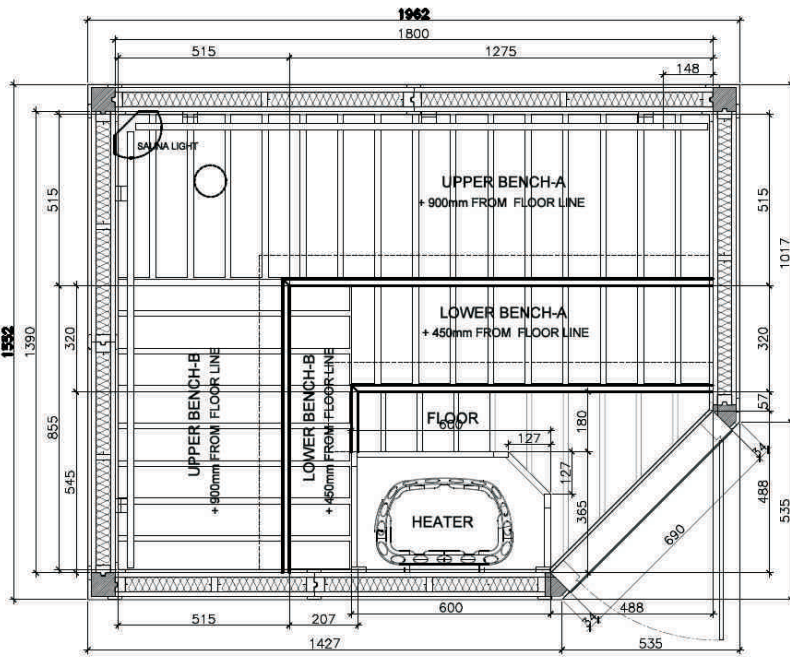

## Standard Sauna Accessories Set



Sauna Heater



Sauna Light Cover with Sauna Light



Wooden Pillow



Pail and Ladle



Thermo hygrometer



Sand Timer

Standard sauna rooms are designed to accommodate 4-6 people and are free standing units designed for indoor installation. Rooms are constructed throughout in Spruce timber, a light softwood that is resistant to warping and gives the sauna a characteristic welcoming appeal. The room is fitted with a glass door and internal benches.

The sauna package also includes a 6kW Premium heater, controller and stones as well as a wooden pail, wooden ladle, covered light, sand timer, wooden pillow and clothes hanger.

External room size is 1.56m x 1.97m x 2.02m height, a capacity of 6.2m<sup>2</sup>

© Davis & Shirtliff 2014. Contents herein are not warranted. The right is reserved to amend specifications without notice. [www.davisandshirtliff.com](http://www.davisandshirtliff.com)

DP256A-01/13

### KENYA

**NAIROBI - HEAD OFFICE**  
 TEL: (+254 20) 6968 000  
[headoffice@dayliff.com](mailto:headoffice@dayliff.com)  
**NAIROBI - WESTLANDS**  
 TEL: (+254 20) 44480116,  
[westlands@dayliff.com](mailto:westlands@dayliff.com)  
**NAIROBI - DOWNTOWN**  
 TEL: (+254 20) 340102  
[downtown@dayliff.com](mailto:downtown@dayliff.com)  
**NAIROBI - KAREN**  
 TEL: (+254 20) 3883513  
[karen@dayliff.com](mailto:karen@dayliff.com)  
**THIKA**  
 TEL: (+254 67) 20084/5  
[thika@dayliff.com](mailto:thika@dayliff.com)  
**ELDORET**  
 TEL: (+254 53) 2061306  
[eldoret@dayliff.com](mailto:eldoret@dayliff.com)

### NAKURU

TEL: (+254 51) 2213248  
[nkroffice@dayliff.com](mailto:nkroffice@dayliff.com)  
**KISUMU**  
 TEL: (+254 57) 2024763  
[ksmoffice@dayliff.com](mailto:ksmoffice@dayliff.com)  
**KISII**  
 TEL: (+254 58) 2030949  
[kisii@dayliff.com](mailto:kisii@dayliff.com)  
**NAIVASHA**  
 TEL: (+254 50) 2030510  
[naivasha@dayliff.com](mailto:naivasha@dayliff.com)  
**MACHAKOS**  
 TEL: (+254 40) 2021668  
[naivasha@dayliff.com](mailto:naivasha@dayliff.com)  
**MERU**  
 TEL: (+254 64) 3131033  
[meru@dayliff.com](mailto:meru@dayliff.com)

### GARISSA

TEL: (+254 46) 2102620  
[garissa@dayliff.com](mailto:garissa@dayliff.com)  
**KENYA COAST**  
**MOMBASA - Main Office**  
 TEL: (+254 20) 2040432  
[d&smasa@dayliff.com](mailto:d&smasa@dayliff.com)  
**MALINDI**  
 TEL: (+254 42) 2120425  
[mldoffice@dayliff.com](mailto:mldoffice@dayliff.com)  
**DIANI**  
 TEL: (+254 40) 3202181  
[dianioffice@dayliff.com](mailto:dianioffice@dayliff.com)  
**LAMU**  
 TEL: (+254 20) 2651052/56  
[lamu@dayliff.com](mailto:lamu@dayliff.com)

### NYALI

TEL: (+254 20) 2443357  
[d&s@nyali.dayliff.com](mailto:d&s@nyali.dayliff.com)  
**VOI**  
 TEL: (+254 20) 2028284  
[voi@dayliff.com](mailto:voi@dayliff.com)  
**ETHIOPIA**  
**ADDIS ABABA**  
 TEL: (+251 11) 5159341/44  
[d&sethiopia@dayliff.com](mailto:d&sethiopia@dayliff.com)  
**RWANDA**  
**KIGALI**  
 TEL: (+250 252) 504039  
[rwoffice@dayliff.com](mailto:rwoffice@dayliff.com)

### UGANDA

**KAMPALA - Main Office**  
 TEL: (+256 414) 346337/8  
[d&skampala@dayliff.com](mailto:d&skampala@dayliff.com)  
**KAMPALA - NAKESERO**  
 TEL: (+256 392) 734633  
[d&snakesero@dayliff.com](mailto:d&snakesero@dayliff.com)  
**GULU**  
 TEL: (+256 471) 433041  
[d&sgulu@dayliff.com](mailto:d&sgulu@dayliff.com)  
**MBARARA**  
 TEL: (+256 753) 940 080  
[d&smbarara@dayliff.com](mailto:d&smbarara@dayliff.com)

### TANZANIA

**DAR ES SALAAM - Main Office**  
 TEL: (+255 22) 2112515/6  
[d&sdarressalaam@dayliff.com](mailto:d&sdarressalaam@dayliff.com)  
**DAR ES SALAAM - KARIAKOO**  
 TEL: (+255 22) 2184867  
[d&skariakoo@dayliff.com](mailto:d&skariakoo@dayliff.com)  
**ARUSHA**  
 TEL: (+255 27) 2547317/8  
[arusaha@dayliff.com](mailto:arusaha@dayliff.com)  
**ZANZIBAR**  
 TEL: (+255 24) 2234660/1  
[zanzibar@dayliff.com](mailto:zanzibar@dayliff.com)  
**MWANZA**  
 TEL: (+255 28) 2541971/2  
[d&smwanza@dayliff.com](mailto:d&smwanza@dayliff.com)

### ZAMBIA

**LUSAKA - Main Office**  
 TEL: (+260 211) 288010/1  
[d&slusaka@dayliff.com](mailto:d&slusaka@dayliff.com)  
**NDOLA**  
 TEL: (+260 212) 610936/7  
[d&sndola@dayliff.com](mailto:d&sndola@dayliff.com)  
**KITWE**  
 TEL: (+260 212) 221747/6/7  
[d&skitwe@dayliff.com](mailto:d&skitwe@dayliff.com)  
**LIVINGSTONE**  
 TEL: (+260 213) 320002/234  
[d&slivingstone@dayliff.com](mailto:d&slivingstone@dayliff.com)  
**SOUTH SUDAN**  
**JUBA**  
 TEL: (+211 956) 397 070  
[juba@dayliff.com](mailto:juba@dayliff.com)