

GRUNDFOS®

MADE IN DENMARK



DATA SHEET

Submersible Sewage Pumps

SL1

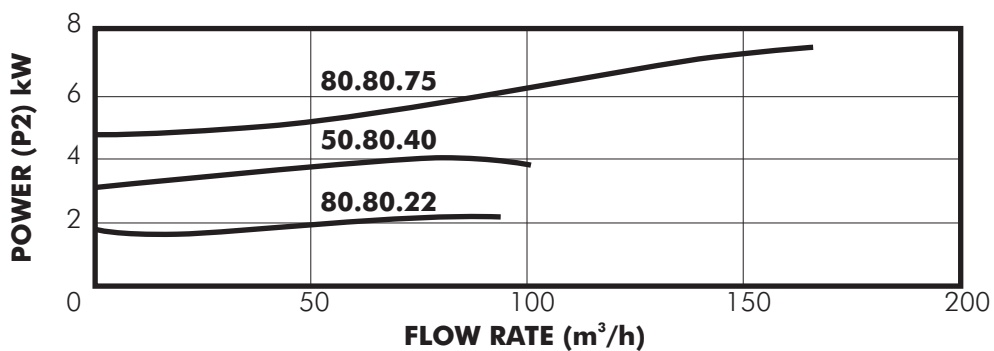
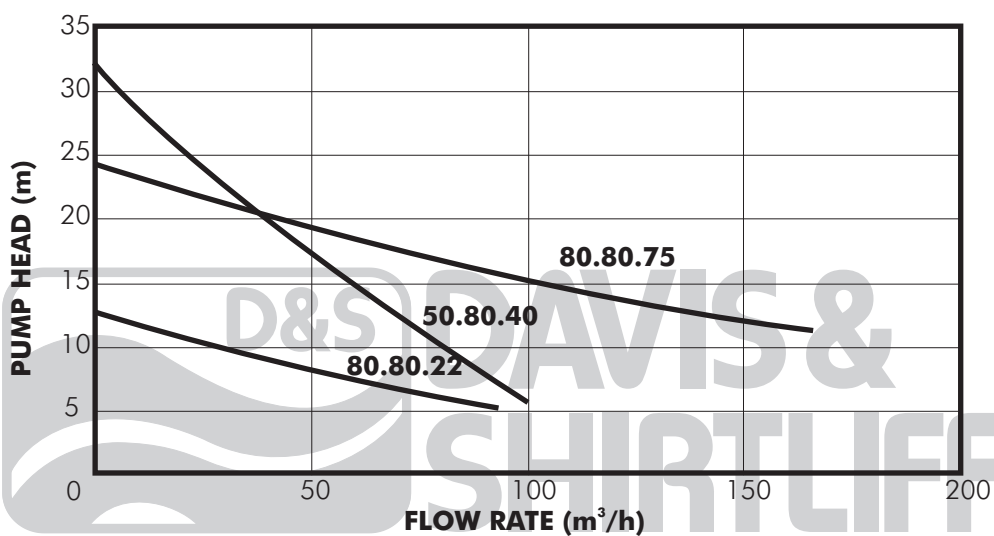

PUMP

The Grundfos SL1 pump range are high specification products for heavy duty pumping applications where reliability and ease of servicing are essential requirements. Particular uses are for pumping sewage and heavily polluted water in municipal, utility and industrial applications.

Featuring advanced technology design, the pumps utilise high efficiency long vane single channel impellers with excellent non-clogging performance and solid passing capability. Other notable features include a hermetically sealed cable entry to eliminate liquid penetration, cartridge type double mechanical seal for durability and ease of maintenance and a simple clamp coupling arrangement of the motor and pump units for easy disassembly.

The SL1 range is of unique modular design and the hydraulic end is configured for submersible auto coupling. Three basic models are stocked, though the range is extensive and different models are available to special order for specific requirements.

The pump end including impeller and pump housing are manufactured from cast iron, the stator housing from cast iron and the motor jacket from stainless steel. 10m of Neoprene rubber drop cable which incorporates wires for thermal sensors in the motor windings is supplied as standard.

MOTOR

Pumps are fitted with integral squirrel cage induction motors that must be fully submerged during operation. Remote motor starting is required using a starter type as indicated below.

Insulation Class: F

Enclosure Class: IP68

Voltage: 3x415V

Max Starts/Hr: 20

OPERATING CONDITIONS

Pumped Liquid: Heavily polluted liquids containing suspended particles up to the through let diameter of the impeller.

Max Liquid Temp: 40°C

Max Immersion Depth: 20m

pH Range: 4 to 10

PUMP DATA

Model	Motor Size (kW)	Speed (rpm)	Max Current (A)	Start Current (A)	Starter Type	Impeller Througlet (mm)	Weight (kgs)
SL1 80.80.22	2.2	1460	5	38	DOL	80	100
SL1 50.80.40	4	2930	9	93	SD	50	123
SL1 80.80.75	7.5	1460	15	109	SD	80	205

DIMENSIONS

Model	Auto-Coupling				
	H (mm)	W (mm)	A (mm)	D (mm)	E (mm)
SL1 80.80.22	790	788	108	432	595
SL1 50.80.40	808	760	132	387	567
SL1 80.80.75	900	883	82	489	690

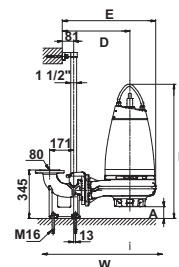
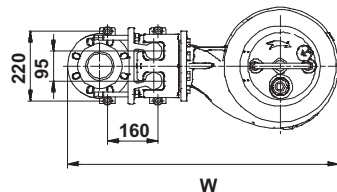

Auto-Coupling

© Davis & Shirtliff 2014. Contents herein are not warranted. The right is reserved to amend specifications without notice. www.davisandshirtliff.com

GR188A-01/11

KENYA
NAIROBI - HEAD OFFICE
 TEL: (+254 20) 6968 000
 headoffice@dayliff.com
NAIROBI - WESTLANDS
 TEL: (+254 20) 44480116,
 westlands@dayliff.com
NAIROBI - DOWNTOWN
 TEL: (+254 20) 340102
 downtown@dayliff.com
NAIROBI - KAREN
 TEL: (+254 20) 3883513
 karen@dayliff.com
THIKA
 TEL: (+254 67) 20084/5
 thika@dayliff.com
ELDORET
 TEL: (+254 53) 2061306
 eldoret@dayliff.com

NAKURU
 TEL: (+254 51) 2213248
 nakuru@dayliff.com
KISUMU
 TEL: (+254 57) 2024763
 ksmoffice@dayliff.com
KISII
 TEL: (+254 58) 2030949
 ksil@dayliff.com
NAIVASHA
 TEL: (+254 50) 2030510
 naivasha@dayliff.com
MACHAKOS
 TEL: (+254 40) 2021668
 naivasha@dayliff.com
MERU
 TEL: (+254 64) 3131033
 meru@eld.dayliff.com

GARISSA
 TEL: (+254 46) 2102620
 garissa@dayliff.com
KENYA COAST
MOBASA - Main Office
 TEL: (+254 20) 2040432
 d&smasa@dayliff.com
MALINDI
 TEL: (+254 42) 2120425
 mloffice@dayliff.com
DIANI
 TEL: (+254 40) 3202181
 dianioffice@dayliff.com
LAMU
 TEL: (+254 20) 265105256
 lamu@dayliff.com

NYALI
 TEL: (+254 20) 2443357
 d&nyali.dayliff.com
VOI
 TEL: (+254 20) 2028284
 voi@dayliff.com
ETHIOPIA
ADDIS ABABA
 TEL: (+251 11) 515934144
 d&sethiopia@dayliff.com
RWANDA
KIGALI
 TEL: (+254 20) 254039
 rwoffice@dayliff.com

UGANDA
KAMPALA - Main Office
 TEL: (+256 414) 3463378
 d&skampala@dayliff.com
KAMPALA - NAKESERO
 TEL: (+256 392) 734633
 d&snakesero@dayliff.com
GULU
 TEL: (+256 471) 433041
 d&sgulu@dayliff.com
MBARARA
 TEL: (+256 753) 940 080
 d&smbarara@dayliff.com

TANZANIA
DAR ES SALAAM - Main Office
 TEL: (+255 22) 21125156
 d&sdaressalaam@dayliff.com
DAR ES SALAAM - KARIAKOO
 TEL: (+255 22) 2184867
 d&skariakoo@dayliff.com
ARUSHA
 TEL: (+255 27) 2547317/8
 arusha@dayliff.com
ZANZIBAR
 TEL: (+255 24) 2234660/1
 zanzibar@dayliff.com
MWANZA
 TEL: (+255 28) 2541971/2
 d&smwanza@dayliff.com

ZAMBIA
LUSAKA - Main Office
 TEL: (+260 211) 288010/1
 d&slusaka@dayliff.com
NDOLA
 TEL: (+260 212) 610936/7
 d&sndola@dayliff.com
KITWE
 TEL: (+260 212) 221747/67
 d&skitwe@dayliff.com
LIVINGSTONE
 TEL: (+260 213) 320002/234
 d&slivingstone@dayliff.com
SOUTH SUDAN
JUBA
 TEL: (+211 956) 397 070
 juba@dayliff.com